

# 23GRM

# 23GS

## Indoor Emergency Safety Shower

### Type: Drench

Ring main mounted unheated emergency safety shower, available with either galvanized mild steel or stainless steel pipework.

Ideal for use where space is at a premium, this general purpose shower is suitable for use in all applications not subject to the possibility of freezing or overheating. Includes universal shower sign for enhanced visibility. ANSI compliant.

*Mounting plate not included.*



## Specifications

MATERIALS OF CONSTRUCTION	
PIPEWORK AND FITTINGS (G)	Galvanized mild steel with tubulars and fittings
PIPEWORK AND FITTINGS (GS)	Stainless steel tubulars and fittings
OPERATING VALVES	316L stainless steel, two piece stay open valve
SHOWER SPRAY OUTLET	Machine molded nylon 6 red shower nozzle
SERVICES	
WATER INLET	1 in Male NPT
DESIGN OPERATING PRESSURE	1.5 to 6 BAR G (22 to 87 PSI)
TEST PRESSURE	10.3 BAR G (149 PSI)
MINIMUM FLOW AT OPERATING PRESSURE	Shower: 76 liters/minute minimum (20 US Gallons)
ENVIRONMENTAL OPERATING TEMPERATURE	
MINIMUM AMBIENT OPERATING TEMPERATURE	5° C (41° F)
MAXIMUM AMBIENT OPERATING TEMPERATURE	35° C (95° F)
OPERATIONAL	
SHOWER OPERATION	Pull handle
NOMINAL WEIGHTS and DIMENSIONS	
DIMENSIONS - STANDARD ORIENTATION (W x D x H)	165 mm (6.5 in) x 651 mm (25.6 in) x 909 mm (35.8 in) Height includes sign
NOMINAL WEIGHT (NO OPTIONS)	3 kg (7 lb)

# HUGHES



HUGHES-SAFETY-SHOWERS.COM

Justrite Safety Group

RM07294 RevA

[hughes-safety-showers.com](http://hughes-safety-showers.com)

**Indoor Emergency Safety Shower :: Type: Drench**

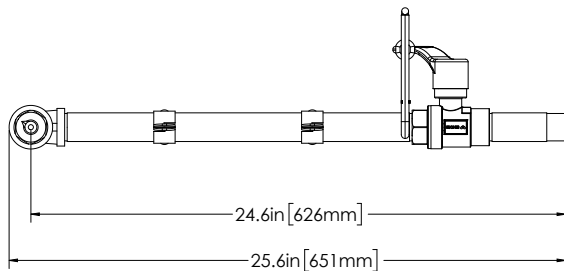
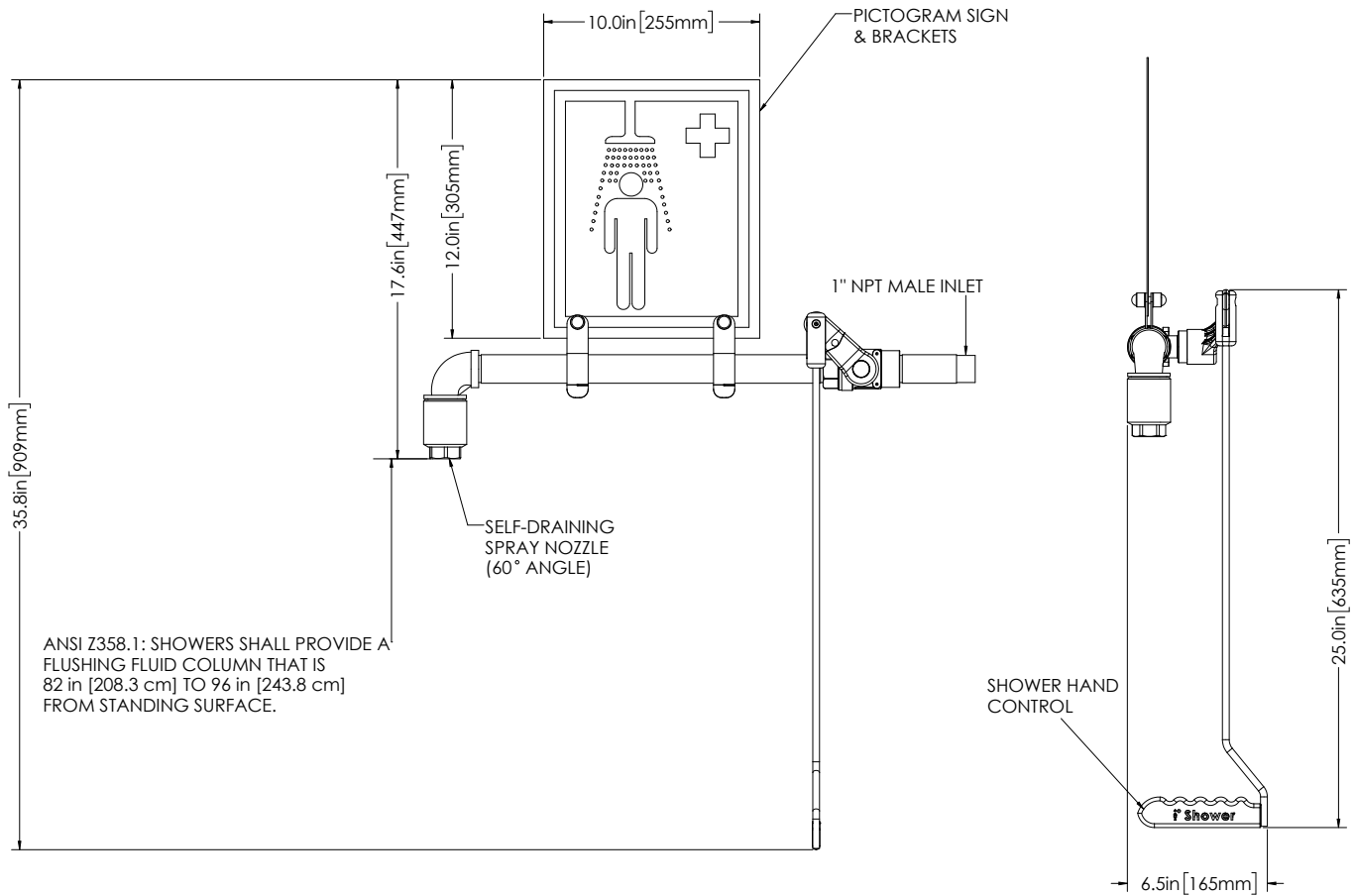

VARIATIONS IN MANUFACTURING AND ASSEMBLY ALLOW FOR ±1/8 IN[3MM] PER THREADED JOINT.

For Technical Support Contact:  
customer.service@hughes-safety.com • 1-866-312-1652

For Reorder & Sales Support Contact:  
custserv@justrite.com • 1-800-798-9250

**HUGHES**

HUGHES-SAFETY-SHOWERS.COM  
Justrite Safety Group

Hughes North America  
457 Campbell Street  
Sarnia, Ontario N7T 2J1, Canada.

Registered No. 0939240. VAT Registration No. 918 5005 32 ©2019 Hughes Safety Showers